

KIT SOLAIRE VÉHICULE 2 X 100W

Installation pas à pas

1 COMPOSITION DU KIT

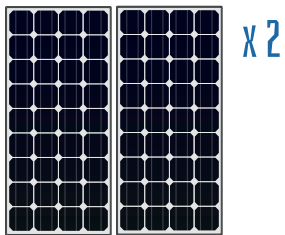

Panneau solaire Monocristallin UNITECK 100W



Câbles panneau (5m / 6mm²)

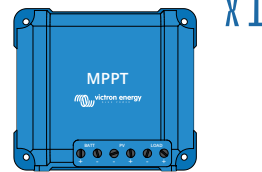

Régulateur Victron MPPT SmartSolar 100/20



Rallonge câble inter-panneaux (1m / 6mm²)



Câble batterie (2m / 6mm²)

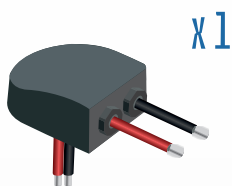

Passerelle étanche double

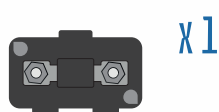

MIDI fusible 60A / 32V



Câble batterie (30cm / 6mm²)



Câble batterie (1.7m / 6mm²)

2 DISPOSITION DES ÉLÉMENTS

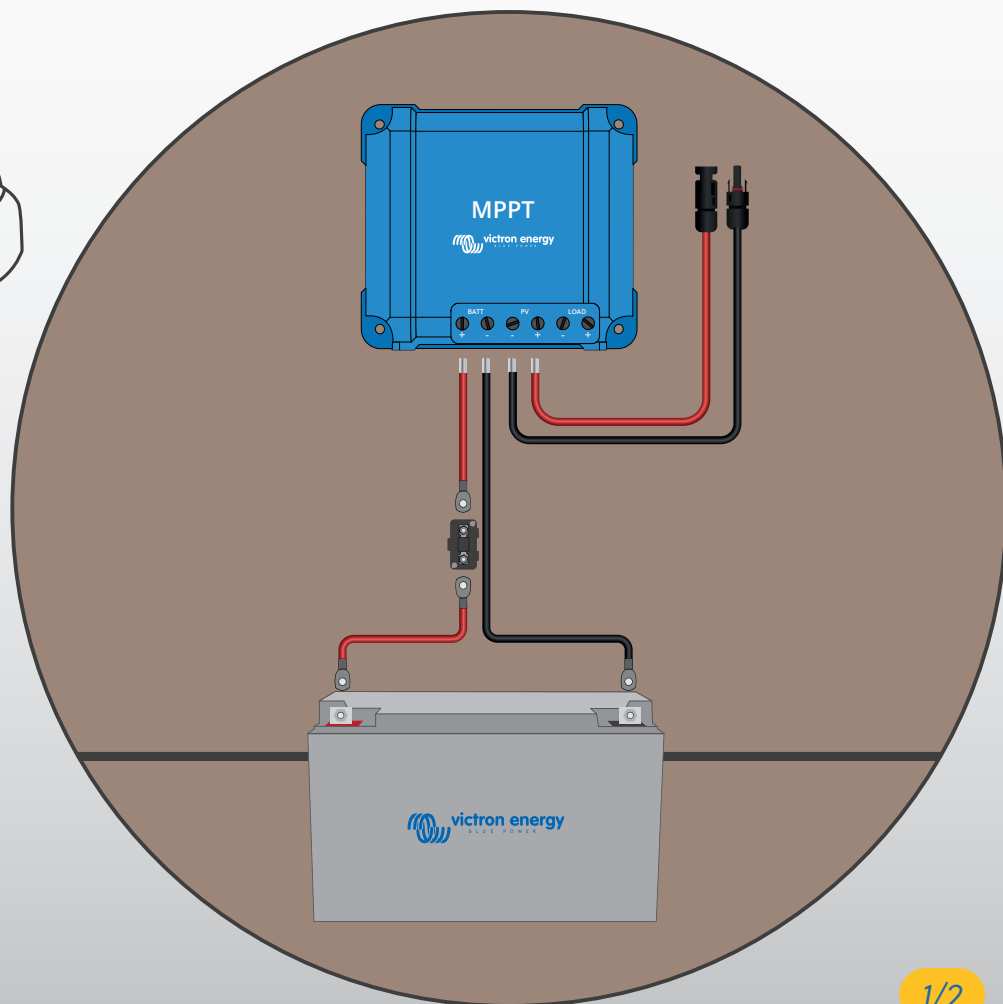
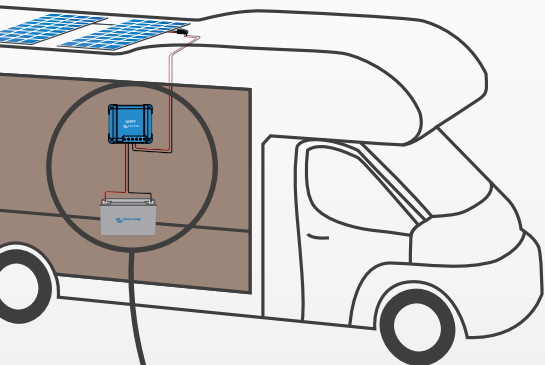

KIT SOLAIRE VÉHICULE 2 X 100W

Installation pas à pas

3 CÂBLAGE BATTERIE



Respecter l'ordre de
branchement

1

2

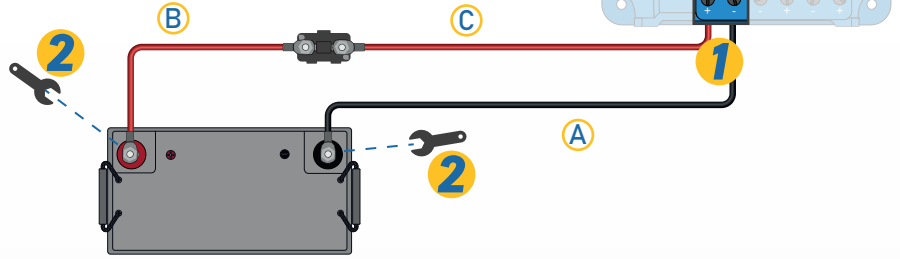
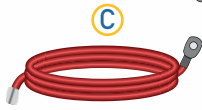
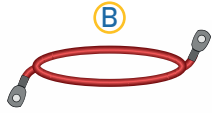

4 CÂBLAGE PANNEAU SOLAIRE

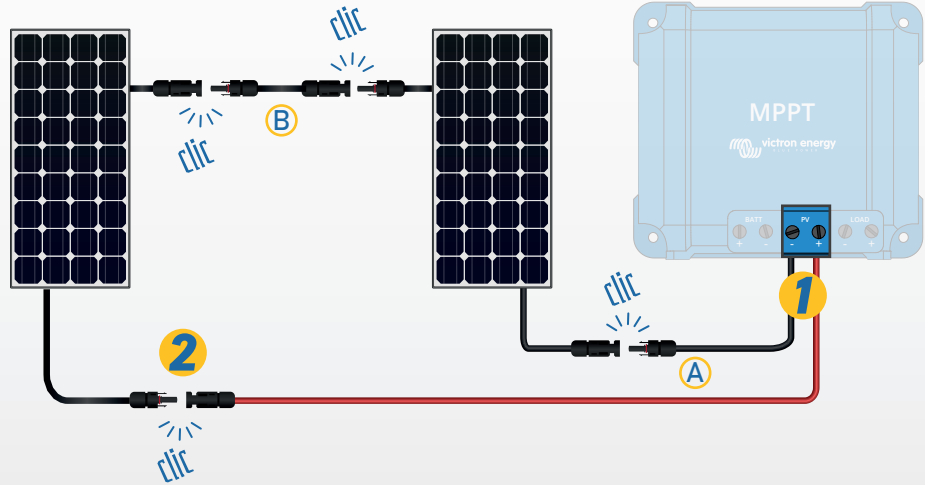

Respecter l'ordre de
branchement

1

2