

KIT SOLAIRE SOUPLE 170W

Installation pas à pas

1 COMPOSITION DU KIT



Panneau solaire Souple
ANTARION 170W + 5m de câble



Cartouche de colle 290ml et
lingettes dégraissantes

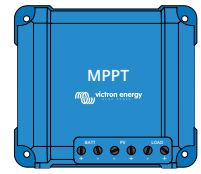

Régulateur Victron
MPPT SmartSolar 75/15

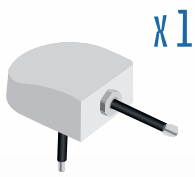

Passeroi étanche simple

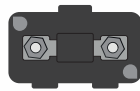

MIDI fusible
60A / 32V



Câble batterie
(2m / 6mm²)



Câble batterie
(30cm / 6mm²)



Câble batterie
(1.7m / 6mm²)

2 DISPOSITION DES ÉLÉMENTS

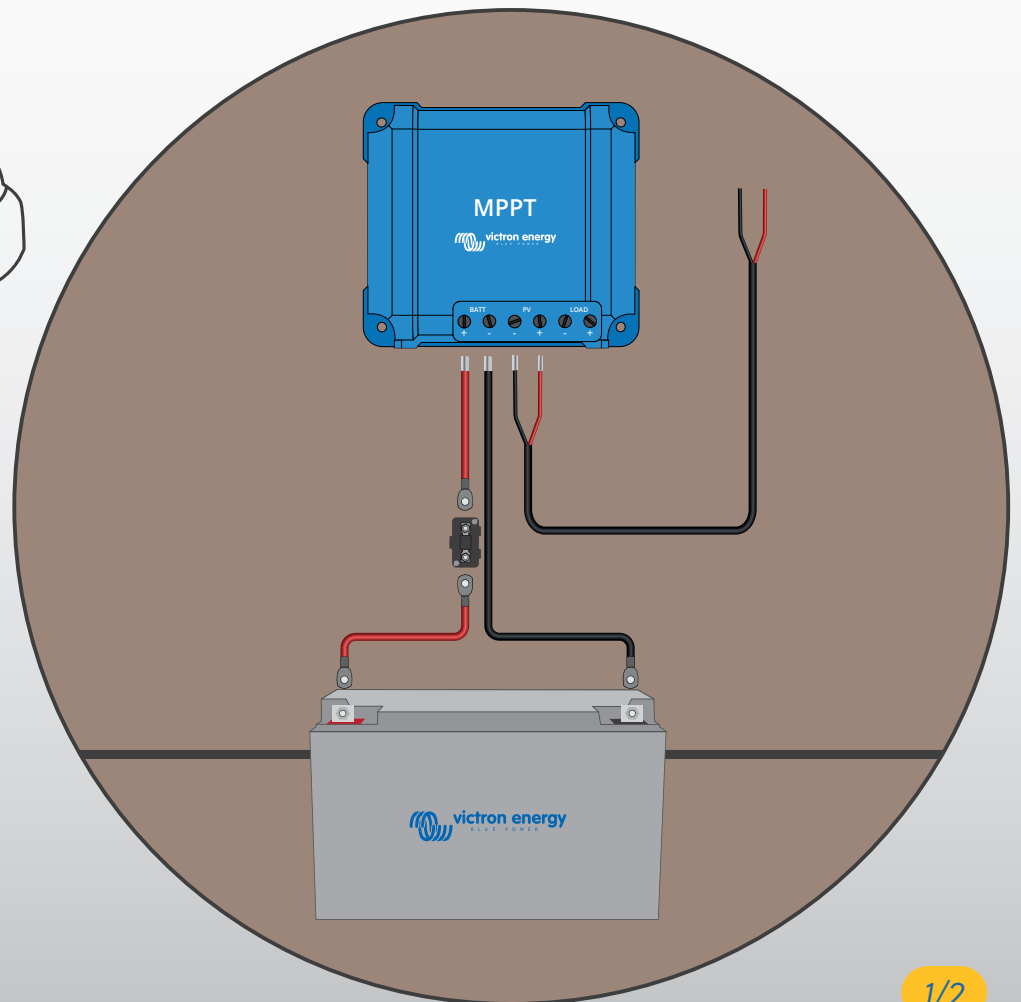
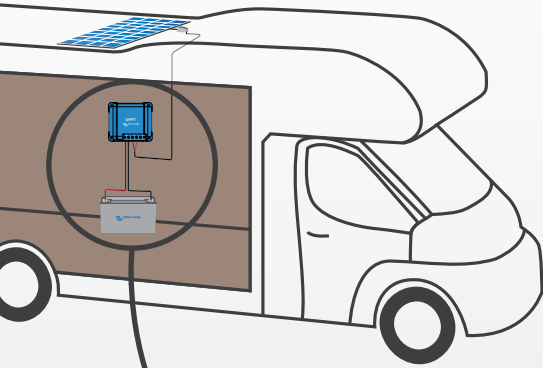

KIT SOLAIRE SOUPLE 170W

Installation pas à pas

3 CÂBLAGE BATTERIE



Respecter l'ordre de
branchement

1

2

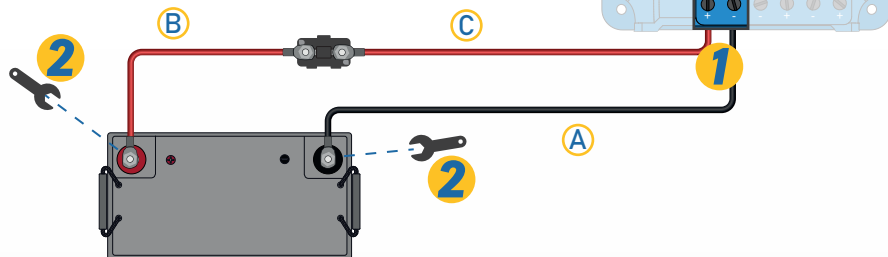
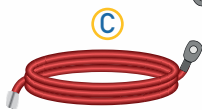
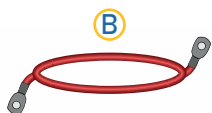

4 CÂBLAGE PANNEAU SOLAIRE

